

RMA 443 VC, 443 PV,
448 VC, 448 PV

STIHL



Instruction Manual



Contents

1	Introduction.....	27
2	Guide to Using this Manual.....	27
3	Overview.....	28
4	Safety Precautions.....	29
5	Preparing the Lawn Mower for Operation.....	35
6	Charging the Battery, LEDs.....	35
7	Activating and Deactivating Bluetooth® Radio Interface.....	35
8	Assembling the Lawn Mower.....	36
9	Adjusting the Lawn Mower for the User.....	37
10	Removing and Fitting the Battery.....	37

11	Inserting and Removing the Activation Key	38
12	Switching the Lawn Mower On and Off.....	38
13	Checking the Lawn Mower and Battery....	39
14	Operating the Lawn Mower.....	40
15	After Finishing Work.....	41
16	Transporting.....	41
17	Storing.....	42
18	Cleaning.....	42
19	Maintenance.....	43
20	Repairing.....	44
21	Troubleshooting.....	44
22	Specifications.....	46
23	Spare Parts and Accessories.....	47
24	Disposal.....	47
25	EC Declaration of Conformity.....	48
26	UKCA Declaration of Conformity.....	48
27	Safety Information for Lawn Mowers.....	49

1 Introduction

Dear Customer,

Thank you for choosing STIHL. We develop and manufacture our quality products to meet our customers' requirements. The products are designed for reliability even under extreme conditions.

STIHL also stands for premium service quality. Our dealers guarantee competent advice and instruction as well as comprehensive service support.

STIHL expressly commit themselves to a sustainable and responsible handling of natural resources. This user manual is intended to help you use your STIHL product safely and in an environmentally friendly manner over a long service life.

We thank you for your confidence in us and hope you will enjoy working with your STIHL product.

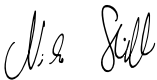

Dr. Nikolas Stihl

IMPORTANT! READ BEFORE USING AND KEEP IN A SAFE PLACE FOR REFERENCE.

2 Guide to Using this Manual

2.1 Applicable Documents

This instruction manual is a translation of the original manufacturer's instructions in the sense of EC Directive 2006/42/EC.

Local safety regulations apply.

- ▶ In addition to this instruction manual, read, understand and keep the following documents:
 - Safety information for the STIHL AP battery
 - Instruction manual for the STIHL AL 101, 301, 301-4, 500 chargers
 - Safety information for STIHL batteries and products with built-in battery: www.stihl.com/safety-data-sheets

Further information on STIHL connected, compatible products and FAQs is available at www.connect.stihl.com or from a STIHL specialist dealer.

The Bluetooth® word mark and figurative marks (logos) are registered trademarks and the property of Bluetooth SIG, Inc. Any use of this word mark/figurative marks by STIHL is under license.

Batteries with  are equipped with a Bluetooth® radio interface. Local operating restrictions (e.g. in airplanes or hospitals) must be observed.

2.2 Warning Notices in Text

DANGER

- This notice refers to risks which result in serious or fatal injury.
 - ▶ Serious or fatal injuries can be avoided by taking the precautions mentioned.

WARNING

- This notice refers to risks which **can** result in serious or fatal injury.
 - ▶ Serious or fatal injuries can be avoided by taking the precautions mentioned.

NOTICE

- This notice refers to risks which can result in damage to property.
 - ▶ Damage to property can be avoided by taking the precautions mentioned.

2.3 Symbols in Text

-  This symbol refers to a chapter in this instruction manual.

3 Overview

3.1 Lawn Mower and Battery

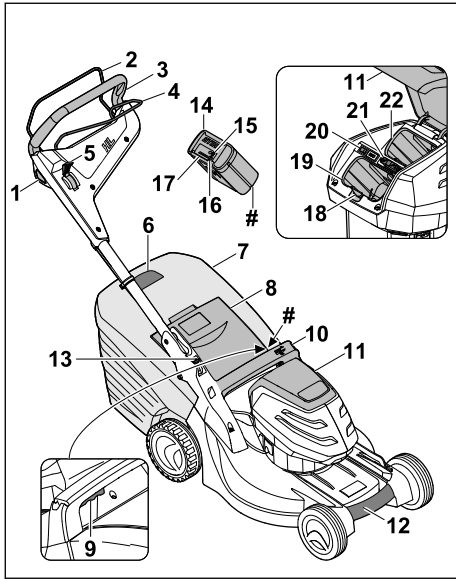















- 1 Locking button**
The locking button switches the blades on and off together with the control bar for mowing.
- 2 Control bar for mowing**
The control bar for mowing switches the blades on and off together with the locking button.
- 3 Handlebar**
The handlebar is used to hold, guide and transport the lawn mower.
- 4 Control bar for self-propulsion**
The control bar for self-propulsion engages and disengages self-propulsion.
- 5 Lever**
The lever is used to set the self-propulsion speed.
- 6 Level indicator**
The level indicator shows how full the grass catcher box is.
- 7 Grass catcher box**
The grass catcher box collects the mown grass.
- 8 Discharge flap**
The discharge flap closes off the discharge chute.

- 9 Lever**
The lever is used to set the cutting height.
 - 10 Handle**
The handle is used to hold the lawn mower when adjusting the cutting height and to transport the lawn mower.
 - 11 Flap**
The flap covers the battery and activation key.
 - 12 Transport handle**
The transport handle is used to transport the lawn mower.
 - 13 Lever**
The lever is used to adjust and fold down the handlebar.
 - 14 Battery**
The battery supplies the lawn mower with power.
 - 15 "BLUETOOTH®" LED (only for batteries with )**
The LED indicates whether the Bluetooth® radio interface is enabled or disabled.
 - 16 Button**
The button activates the LEDs on the battery. It enables and disables the Bluetooth® radio interface (if present).
 - 17 LEDs**
The LEDs indicate the battery charge state and faults.
 - 18 Locking lever**
The locking lever keeps the battery in the battery compartment.
 - 19 Battery compartment**
The battery compartment holds the battery.
 - 20 ECO switch**
The ECO switch activates and deactivates ECO mode.
 - 21 Activation key**
The activation key activates the lawn mower.
- RMA 443.2 PV, RMA 448.2 PV:**
- 22 Battery compartment**
The battery compartment holds a second battery.
- RMA 443.2 VC, RMA 448.2 VC:**
- 22 Transport compartment**
The transport compartment holds a replacement battery.
- # Rating plate with machine number**

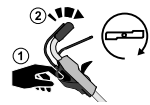
3.2 Symbols

The symbols can be on the lawn mower or battery and have the following meaning:

-  This symbol identifies the activation key.
-  This symbol identifies the key receptacle.
-  This symbol identifies the ECO switch.
-  This symbol identifies the lever for setting the cutting height.
-  This symbol indicates the weight of the lawn mower without battery.
-  1 LED illuminates red. The battery is too warm or too cold.
-  4 LEDs flashing red. There is a fault in the battery.
-  **LWA** Guaranteed sound power level in accordance with Directive 2000/14/EC in dB(A) for the purpose of comparing the sound emissions of products.
-  The battery has a Bluetooth® radio interface and can be connected to the STIHL connected app.
-  The number beside the symbol indicates the energy content of the battery according to the cell manufacturer's specifications. The available energy content is lower in practice.
-  Do not dispose of the product with domestic waste.
-  Activating and deactivating the blade.
-  Setting the driving speed.
-  The lawn mower moves at its fastest speed in this setting.
-  The lawn mower moves at its slowest speed in this setting.

4 Safety Precautions

4.1 Warning Symbols

The warning symbols on the lawn mower or battery have the following meaning:

-  Follow the safety instructions and their measures.
-  Read, understand and keep the instruction manual.
-  Beware of objects being thrown up - keep a safe distance and keep other people away.
-  Do not touch a turning blade.
-  Remove the battery during work stoppages, transport, storage, maintenance or repair.
-  Pull out the activation key during work stoppages, transport, storage, maintenance or repair.
-  Maintain a safety distance.
-  Protect the battery from heat and fire.
-  Do not immerse the battery in liquids.
-  Observe the permissible temperature range for the battery.

4.2 Intended Use

The STIHL RMA 443.2 VC, RMA 443.2 PV, RMA 448.2 VC or RMA 448.2 PV lawn mower is used to mow dry grass.

The lawn mower is supplied with power by a STIHL AP battery.

The battery with  allows personalisation and transmission of information to the battery in combination with the STIHL connected app on the basis of Bluetooth® technology.

▲ WARNING

- Batteries not approved by STIHL for the lawn mower may cause fires and explosions. This may result in serious or fatal injury to people and damage to property.
 - ▶ Use the lawn mower with a STIHL AP battery.
- Failure to use the lawn mower or battery as intended may result in serious or fatal injury to people and damage to property.
 - ▶ Use the lawn mower as described in this instruction manual.
 - ▶ Use the battery as described in this instruction manual, the STIHL connected app and at www.connect.stihl.com.

4.3 Requirements for the User

▲ WARNING

- Uninstructed users cannot recognise or evaluate the dangers posed by the lawn mower and battery. This may result in serious or fatal injury to the user or other people.



- ▶ Read, understand and keep the instruction manual.

- ▶ If passing on the lawn mower or battery to another person: provide them with the instruction manual also.
- ▶ Make sure that the user meets the following conditions:
 - The user is rested.
 - The user is physically, sensorily and mentally capable of operating the lawn mower and battery and working with them. If the user is physically, sensorily or mentally impaired, the machine must only be used under supervision or following instruction by a responsible person.
 - The user can recognise and evaluate the dangers posed by the lawn mower and battery.
 - The user is aware that they are responsible for accidents and damage.
 - The user is of legal age or the user is being trained under supervision in a profession in accordance with national regulations.
 - The user has received instruction from a STIHL specialist dealer or a competent person before using the lawn mower for the first time.

- The user is not impaired by alcohol, medicines or drugs.
- ▶ If anything is unclear: consult a STIHL specialist dealer.

4.4 Clothing and Equipment

▲ WARNING

- Objects may be thrown up at high velocity while working. This may result in injury to the user.
 - ▶ Wear long trousers made from resistant material.
- Dust may be stirred up while working. Breathing in dust may be harmful to health and cause allergic reactions.
 - ▶ If dust is stirred up: wear a dust mask.
- Unsuitable clothing may get caught on wood, briars and in the lawn mower. This may result in serious injury to the user.
 - ▶ Wear close-fitting clothing.
 - ▶ Remove scarves and jewellery.
- The user may come into contact with the blade during cleaning, maintenance or transport. This may result in injury to the user.
 - ▶ Wear protective gloves.
- Wearing unsuitable footwear may cause the user to slip. This may result in injury to the user.
 - ▶ Wear sturdy, closed-toed footwear with high-grip soles.
- Material particles may be expelled when sharpening the blade. This may result in injury to the user.
 - ▶ Wear close-fitting safety glasses. Suitable safety glasses are tested in accordance with EN 166 or national regulations and available commercially with the corresponding marking.
 - ▶ Wear protective gloves.

4.5 Work Area and Surroundings

4.5.1 Lawn Mower

▲ WARNING

- Bystanding people, children and animals cannot recognise or evaluate the dangers posed by the lawn mower and objects expelled at high speed by the mower. This may result in serious injury to bystanding people, children and animals and damage to property.



- ▶ Keep bystanding people, children and animals out of the work area.

- ▶ Maintain a safety distance from objects.

- ▶ Do not leave the lawn mower unattended.
- ▶ Make sure that children cannot play with the lawn mower.
- Working in the rain may cause the user to slip. This may result in serious or fatal injury to the user.
 - ▶ Do not work when it is raining.
- The lawn mower is not waterproof. Working in the rain or in a damp environment may result in electric shock. This may result in injury to the user and damage to the lawn mower.
 - ▶ Do not work in the rain or in a damp environment.
 - ▶ Do not mow wet grass.
- Electrical components of the lawn mower may produce sparks. Sparks may cause fires and explosions in highly flammable or explosive environments. This may result in serious or fatal injury to people and damage to property.
 - ▶ Do not work in a highly flammable or explosive environment.

4.5.2 Battery

▲ WARNING

- Bystanders, children and animals cannot recognize or assess the dangers of the battery. Bystanders, children and animals may be seriously injured.
 - ▶ Keep bystanders, children and animals away from the work area.
 - ▶ Do not leave the battery unattended.
 - ▶ Make sure that children cannot play with the battery.
- The battery is not protected against all ambient conditions. If the battery is exposed to certain ambient conditions, the battery may catch fire, explode or be irreparably damaged. This may result in serious injury to people and damage to property.



- ▶ Protect battery from heat and fire.
- ▶ Do not throw the battery into a fire.



- ▶ Use and store the battery at temperatures between - 10 °C and + 50 °C.



- ▶ Do not immerse the battery in fluids.

- ▶ Keep battery away from small metal parts.
- ▶ Do not expose the battery to high pressure.
- ▶ Do not expose the battery to microwaves.
- ▶ Protect the battery from chemicals and salts.

4.6 Safe Condition

4.6.1 Lawn Mower

The lawn mower is in safe condition when the following conditions are met:

- The lawn mower is undamaged.
- The lawn mower is clean and dry.
- The controls are working and have not been modified.
- The blade is correctly attached.
- Genuine STIHL accessories for this lawn mower are attached.
- The accessories are correctly attached.

▲ WARNING

- If not in safe condition, components may no longer operate correctly and safety devices may be disabled. This may result in serious or fatal injury to people.
 - ▶ Do not use a damaged lawn mower.
 - ▶ If the lawn mower is dirty or wet: clean the lawn mower and allow it to dry.
 - ▶ Do not modify the lawn mower.
 - ▶ If the controls are not working: do not use the lawn mower.
 - ▶ Attach genuine STIHL accessories for this lawn mower.
 - ▶ Attach the blade as described in this instruction manual.
 - ▶ Attach accessories as described in this instruction manual or in the instruction manual for the accessories.
 - ▶ Do not insert objects into the apertures in the lawn mower.
 - ▶ Never connect the key receptacle terminals to metallic objects and cause a short circuit.
 - ▶ Replace worn or damaged warning signs.
 - ▶ If anything is unclear: consult a STIHL specialist dealer.

4.6.2 Blade

The blade is in safe condition when the following conditions are met:

- The blade and attachments are undamaged.
- The blade is not deformed.
- The blade is correctly attached.
- The blade is correctly sharpened.
- The blade is burr-free.
- The blade is correctly balanced.
- The minimum thickness and minimum width of the blade are not fallen below, 22.2.
- The sharpening angle is observed, 22.2.

▲ WARNING

- In unsafe condition, blade parts may come loose and be expelled. This may result in serious injury to people.
 - ▶ Use an undamaged blade and attachments.
 - ▶ Attach the blade correctly.
 - ▶ Sharpen the blade correctly.
 - ▶ If the minimum thickness or minimum width is fallen below: replace the blade.
 - ▶ Have the blade balanced by a STIHL specialist dealer.
 - ▶ If anything is unclear: consult a STIHL specialist dealer.

4.6.3 Battery

The battery is in safe condition when the following conditions are met:

- The battery is not damaged.
- The battery is clean and dry.
- The battery is working and has not been modified.

▲ WARNING

- The battery cannot function safely if it is not in safe condition. There is a risk of serious injury to persons.
 - ▶ Use an undamaged and functioning battery.
 - ▶ Do not charge a damaged or defective battery.
 - ▶ If the battery is dirty or wet: clean the battery and allow it to dry.
 - ▶ Do not modify the battery.
 - ▶ Do not insert objects into the apertures in the battery.
 - ▶ Never connect the battery terminals to metallic objects and cause a short circuit.
 - ▶ Do not open the battery.
 - ▶ Replace worn or damaged warning signs.
- Fluid may leak from a damaged battery. If the fluid contacts the skin or eyes, this may cause irritation.
 - ▶ Avoid contact with the fluid.
 - ▶ In the event of contact with the skin: wash the affected areas with plenty of soap and water.
 - ▶ In the event of contact with the eyes: rinse the eyes with plenty of water for at least 15 minutes and seek medical attention.
- A damaged or defective battery may emit an unusual odour, smoke or catch fire. This may result in serious or fatal injury to people and damage to property.
 - ▶ If the battery emits an unusual odour or smoke: do not use the battery and keep it away from flammable materials.

- ▶ If the battery catches fire: try to extinguish the battery using a fire extinguisher or water.

4.7 Working

▲ WARNING

- In certain situations, the user may no longer be able to concentrate on their work. This may result in the user stumbling, falling and becoming seriously injured.
 - ▶ Work calmly and carefully.
 - ▶ If the light and visibility conditions are poor: do not use the lawn mower.
 - ▶ Operate the lawn mower alone.
 - ▶ Watch out for obstacles.
 - ▶ Do not tilt the lawn mower.
 - ▶ Work standing on the ground and maintain balance.
 - ▶ If signs of fatigue occur: take a break.
 - ▶ If mowing on a slope: mow across the slope.
 - ▶ Do not work on slopes with an inclination greater than 25° (46.6%).
- The turning blade may cut the user. This may result in serious injury to the user.



- ▶ Do not touch a turning blade.
 - ▶ If the blade is blocked by an object: switch the lawn mower off, pull out the activation key and remove the battery. Only then remove the object.
- If working without self-propulsion when mowing, self-propulsion may unintentionally be engaged and the lawn mower may start moving. This may result in serious injury to people and damage to property.
 - ▶ Only press the control bar for self-propulsion if self-propulsion is to be engaged.
- If the lawn mower changes or starts to behave differently when working, it may not be in safe condition. This may result in serious injury to people and damage to property.
 - ▶ Stop working, pull out the activation key, remove the battery and consult a STIHL specialist dealer.
- The lawn mower may cause vibrations when working.
 - ▶ Wear gloves.
 - ▶ Take breaks.
 - ▶ If signs of a circulatory disturbance occur: consult a doctor.
- If the blade hits a foreign object when working, the foreign object or parts of it may be damaged or thrown up at high velocity. This may result in injury to people and damage to property.

- ▶ Remove foreign objects from the work area.
- When the control bar for mowing is released, the blade continues to turn for a short time. This may result in serious injury to people.
 - ▶ Wait until the blade is no longer turning.
- Sparks may be produced if the turning blade hits a hard object. Sparks may cause fires in highly flammable environments. This may result in serious or fatal injury to people and damage to property.
 - ▶ Do not work in a highly flammable environment.
- If the lawn mower is stopped on a sloping surface, it may unintentionally roll away. This may result in injury to people and damage to property.
 - ▶ Only let go of the lawn mower if it is on a level surface and cannot roll away by itself.
- If objects are attached to the handlebar, the additional weight may cause the lawn mower to tip over. This may result in injury to people and damage to property.
 - ▶ Do not attach objects to the handlebar.

▲ DANGER

- If working near live wires, the blade may come into contact with the live wires and damage them. This may result in serious or fatal injury to the user.
 - ▶ Do not work near live wires.
- The user may be struck by lighting if working during a thunderstorm. This may result in serious or fatal injury to the user.
 - ▶ Do not work during thunderstorms.

4.8 Transporting

4.8.1 Lawn Mower

▲ WARNING

- The lawn mower may tip over or move during transport. This may result in injury to people and damage to property.



- ▶ Pull out the activation key.



- ▶ Remove the battery.

- ▶ Secure the lawn mower with lashing straps, belts or a net so it cannot tip over and move.
- If the activation key and battery are inserted during transport with self-propulsion disengaged, self-propulsion may unintentionally be

engaged and the lawn mower may start moving. This may result in serious injury to people and damage to property.



- ▶ Pull out the activation key.



- ▶ Remove the battery.

4.8.2 Battery

▲ WARNING

- The battery is not protected against all ambient conditions. The battery may be damaged if it is exposed to certain ambient conditions, and damage to property may occur.
 - ▶ Never transport a damaged battery.
- The battery may turn over or shift during transport. This may result in injury to people and damage to property.
 - ▶ Pack the battery in packaging in such a way that it cannot move.
 - ▶ Secure the packaging so that it cannot move.

4.9 Storing

4.9.1 Lawn Mower

▲ WARNING

- Children cannot recognise or evaluate the dangers posed by the lawn mower. There is a risk of serious injury to children.



- ▶ Pull out the activation key.



- ▶ Remove the battery.

- ▶ Keep the lawn mower out of reach of children.
- Moisture may cause corrosion to the electrical contacts on the lawn mower and metal components. This may result in damage to the lawn mower.



- ▶ Pull out the activation key.



- ▶ Remove the battery.

- ▶ Keep the lawn mower clean and dry.
- If the activation key and battery are inserted during storage, the blade and self-propulsion may unintentionally be engaged and the lawn mower may start moving. This may result in serious injury to people and damage to property.



- ▶ Pull out the activation key.



- ▶ Remove the battery.

- If the lawn mower is kept on a sloping surface, it may unintentionally roll away. This may result in injury to people and damage to property.
 - ▶ The lawn mower should only be kept on level surfaces.

4.9.2 Battery

▲ WARNING

- Children cannot recognise or evaluate the dangers posed by batteries. There is a risk of serious injury to children.
 - ▶ Keep the battery out of reach of children.
- The battery is not protected against all ambient conditions. If exposed to certain ambient conditions, the battery may be irreparably damaged.
 - ▶ Keep the battery clean and dry.
 - ▶ Store the battery in a closed room.
 - ▶ Store the battery separately from the lawn mower.
 - ▶ If the battery is stored in the charger: disconnect the mains plug and store the battery at a charge state between 40% and 60% (2 LEDs illuminated green).
 - ▶ Use and store the battery at temperatures between - 10 °C and + 50 °C.

4.10 Cleaning, Maintenance and Repair

▲ WARNING

- If the activation key and battery are inserted during cleaning, maintenance or repair, the blade may unintentionally be activated. This may result in serious injury to people and damage to property.



- ▶ Pull out the activation key.



- ▶ Remove the battery.

- If the activation key and battery are inserted during cleaning, maintenance and repair, self-propulsion may unintentionally be engaged and the lawn mower may start moving. This may result in serious injury to people and damage to property.



- ▶ Pull out the activation key.



- ▶ Remove the battery.

- Abrasive cleaning agents, using a water jet for cleaning or sharp objects may result in damage to the lawn mower, blade and battery. If the lawn mower, blade and battery are not cleaned correctly, components may no longer operate correctly and safety devices may be disabled. This may result in serious injury to people.
 - ▶ Clean the lawn mower, blade and battery as described in this instruction manual.
- If the lawn mower, blade or battery are not maintained or repaired correctly, components may no longer operate correctly and safety devices may be disabled. This may result in serious or fatal injury to people.
 - ▶ Do not maintain or repair the lawn mower or battery yourself.
 - ▶ If the lawn mower or battery need to be maintained or repaired: consult a STIHL specialist dealer.
 - ▶ Maintain the blade as described in this instruction manual.
- The user may cut themselves on sharp cutting edges during blade cleaning, maintenance or repair. This may result in injury to the user.
 - ▶ Wear work gloves made from resistant material.
- The blade may become hot during sharpening. This may result in the user burning themselves.
 - ▶ Wait until the blade has cooled down.
 - ▶ Wear work gloves made from resistant material.

5 Preparing the Lawn Mower for Operation

5.1 Preparing the Lawn Mower for Operation

The following steps must be performed before commencing work:

- ▶ Remove packaging material and transport locks.
- ▶ Make sure that the following components are in safe condition:
 - Lawn mower, 4.6.1.
 - Blade, 4.6.2.
 - Battery, 4.6.3.
- ▶ Check the battery, 13.3.
- ▶ Fully charge the battery, 6.1.
- ▶ Clean the lawn mower, 18.2.
- ▶ Check the blade, 13.2.
- ▶ Attach the handlebar, 8.1.
- ▶ Fold up and adjust the handlebar, 9.1.
- ▶ If mowing and the mown grass is to be collected in the grass catcher box: attach the grass catcher box, 8.2.2.
- ▶ If mowing and the mown grass is to be ejected to the rear: detach the grass catcher box, 8.2.3.
- ▶ Set the cutting height, 14.2.
- ▶ Check the controls, 13.1.
- ▶ If the steps cannot be performed: do not use the lawn mower and consult a STIHL specialist dealer.

5.2 Connecting a battery with Bluetooth® radio interface with the STIHL connected app

- ▶ Activate the Bluetooth® radio interface on the mobile device.
- ▶ Activating the Bluetooth® radio interface on the battery, 7.1.
- ▶ Download the STIHL connected app to the mobile device from the App Store and create an account.
- ▶ Open and sign in to the STIHL connected app.
- ▶ Add the battery in the STIHL connected app and follow the instructions on the screen.

For contacts and other information, please visit <https://support.stihl.com> or see the STIHL connected app.

The STIHL connected app is available internationally.

6 Charging the Battery, LEDs

6.1 Charging the Battery

The charging time depends on various factors, e.g. the battery temperature or the ambient temperature. The actual charging time may vary from the charging time indicated. The charging time is indicated at www.stihl.com/charging-times.

- ▶ Recharge the battery as described in the User Manual for the STIHL AL 101, 301, 301-4, 500 chargers.

6.2 Displaying the Charge State

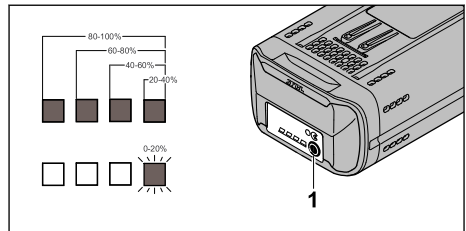

- ▶ Press button (1).
The LEDs illuminate green for approx. 5 seconds to indicate the charge state.
- ▶ If the right LED flashes green: charge the battery.

6.3 LEDs on Battery

The LEDs can show the state of charge or malfunctions. The LEDs can glow or flash green or red.

The state of charge is indicated when the LEDs glow or flash green.

- ▶ If the LEDs glow or flash red: Troubleshooting, 21.1.
There is a malfunction in the mower or battery.

7 Activating and Deactivating Bluetooth® Radio Interface

7.1 Activating the Bluetooth® Radio Interface

- ▶ If the battery has a Bluetooth® radio interface: Press and hold the pushbutton until the "BLUETOOTH®" LED next to the symbol lights up blue for approximately 3 seconds. The Bluetooth® radio interface on the battery is activated.

7.2 Deactivating the Bluetooth® Radio Interface

- ▶ If the battery has a Bluetooth® radio interface: Press and hold the pushbutton until the "BLUETOOTH®" LED next to the **C** symbol lights up blue six times. The Bluetooth® radio interface on the battery is deactivated.

8 Assembling the Lawn Mower

8.1 Attaching the Handlebar

- ▶ Switch the lawn mower off, pull out the activation key and remove the battery.
- ▶ Place the lawn mower on a level surface.

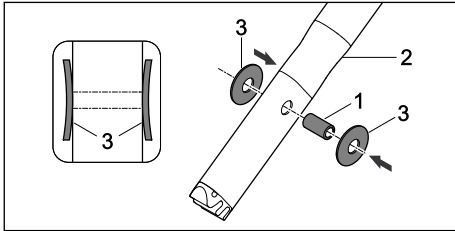

- ▶ Press sleeve (1) into the bores in upper handlebar (2).
- ▶ Fit spring washers (3) with the convex side facing inwards onto sleeve (1).

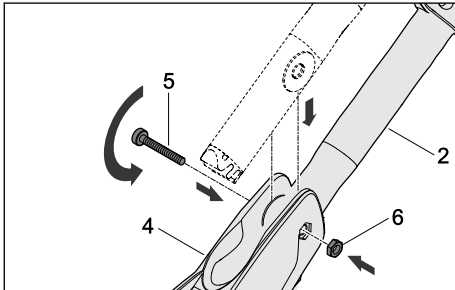

- ▶ Guide upper handlebar (2) into handlebar bracket (4).
- ▶ Push bolt (5) through the bores in handlebar bracket (4) and the sleeve in upper handlebar (2).
- ▶ Place nut (6) in the notch in handlebar bracket (4).
- ▶ Tighten bolt (5).

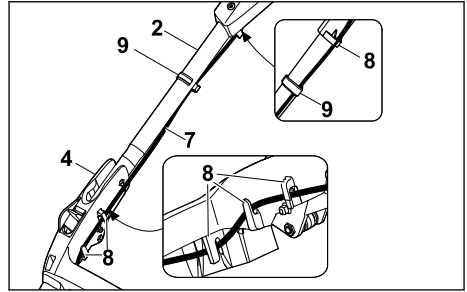

- ▶ Press cable (7) into holders (8).
- ▶ Fasten cable (7) to the handlebar using cable clip (9).

The handlebar must not be dismantled again.

8.2 Assembling, Attaching and Detaching the Grass Catcher Box

8.2.1 Assembling the Grass Catcher Box

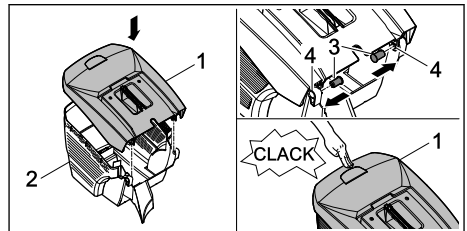

- ▶ Fit upper part of grass catcher box (1) onto lower part of grass catcher box (2).
- ▶ Press pins (3) through openings (4) from the inside.
- ▶ Press upper part of grass catcher box (1) downwards. The upper part of the grass catcher box engages with a click.

8.2.2 Attaching the Grass Catcher Box

- ▶ Switch the lawn mower off.
- ▶ Place the lawn mower on a level surface.

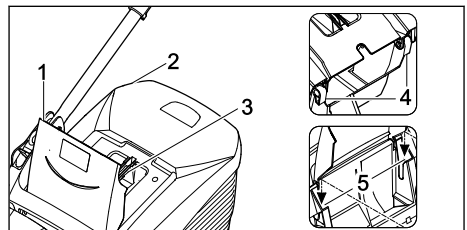

- ▶ Open discharge flap (1) and hold it open.

- ▶ Take hold of grass catcher box (2) by handle (3) and attach to mounts (5) using hooks (4).
- ▶ Set down discharge flap (1) on grass catcher box (2).

8.2.3 Detaching the Grass Catcher Box

- ▶ Switch the lawn mower off.
- ▶ Place the lawn mower on a level surface.
- ▶ Open the discharge flap and hold it open.
- ▶ Remove the grass catcher box upwards by the handle.
- ▶ Close the discharge flap.

9 Adjusting the Lawn Mower for the User

9.1 Adjusting the Handlebar

- ▶ Switch the lawn mower off, pull out the activation key and remove the battery.
- ▶ Place the lawn mower on a level surface.

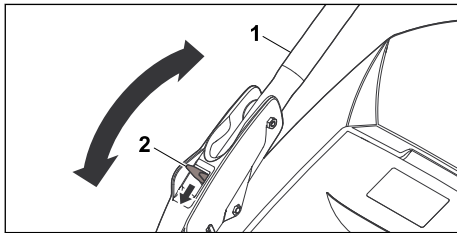

- ▶ Hold handlebar (1).
- ▶ Press lever (2) downwards and hold.
- ▶ Move handlebar (1) into the desired position.
- ▶ Release lever (2) and ensure that the handlebar fully engages again.

9.2 Folding the Handlebar

The handlebar can be folded for space-saving transport or storage.

- ▶ Switch the lawn mower off, pull out the activation key and remove the battery.
- ▶ Place the lawn mower on a level surface.
- ▶ Press and hold the lever.
- ▶ Fold down the handlebar forwards.

10 Removing and Fitting the Battery

10.1 Fitting the Battery

RMA 443 PV and RMA 448 PV:

The RMA 443 PV and RMA 448 PV lawn mowers can be operated with two batteries. As soon as the battery in the first battery compartment (3)

is discharged, the machine automatically switches to the battery in the second battery compartment (4). There must always be a battery in the first battery compartment (3) when working.

RMA 443 VC and RMA 448 VC:

The RMA 443 VC and RMA 448 VC lawn mowers are equipped with a battery compartment (3) and a transport compartment (4). The lawn mowers can only be operated with the battery in battery compartment (3). A replacement battery can be carried in transport compartment (4).

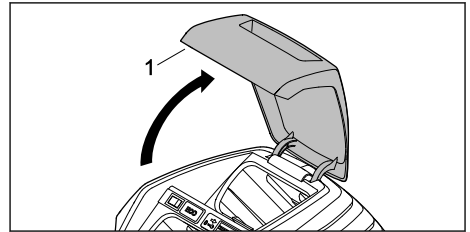

- ▶ Open flap (1) as far as the stop and hold.

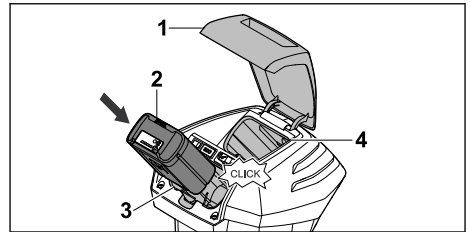

- ▶ Push battery (2) into battery compartment (3) as far as it will go. Battery (2) engages with a click and is locked in place.
- ▶ If a second battery is to be carried: fit the battery in battery compartment (4) or transport compartment (4). The battery engages with a click and is locked in place.
- ▶ Close flap (1).

10.2 Removing the Battery

- ▶ Place the lawn mower on a level surface.
- ▶ Open flap (1) as far as the stop and hold.

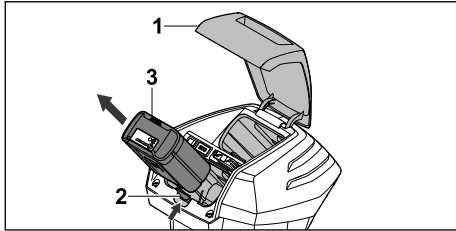

- ▶ Press locking lever (2).
- ▶ Battery (3) is released.
- ▶ Remove battery (3).
- ▶ Close flap (1).

11 Inserting and Removing the Activation Key

11.1 Inserting the Activation Key

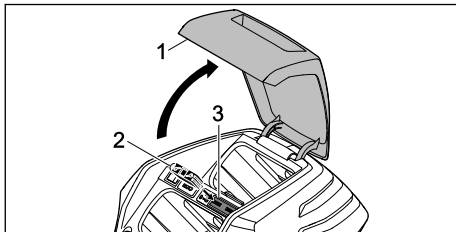

- ▶ Open flap (1) as far as the stop and hold.
- ▶ Insert activation key (2) in key receptacle (3).
- ▶ Close flap (1).

11.2 Removing the Activation Key

- ▶ Open the flap as far as the stop and hold.
- ▶ Pull out the activation key.
- ▶ Close the flap.
- ▶ Keep the activation key out of the reach of children.

12 Switching the Lawn Mower On and Off

12.1 Activating and Deactivating the Blade

12.1.1 Activating the Blade

- ▶ Place the lawn mower on a level surface.

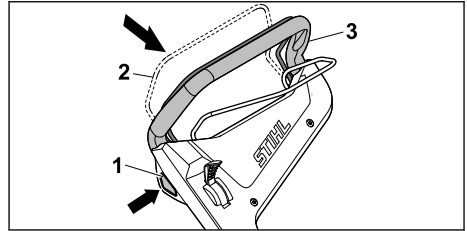

- ▶ Press locking button (1) with the right hand and hold.
- ▶ Pull control bar for mowing (2) with the left hand fully in the direction of handlebar (3) and hold so the thumb encloses handlebar (3). The blade turns.
- ▶ Release locking button (1).
- ▶ Hold handlebar (3) and control bar for mowing (2) with the right hand so the thumb encloses handlebar (3).

12.1.2 Deactivating the Blade

- ▶ Release the control bar for mowing.
 - ▶ Wait until the blade is no longer turning.
 - ▶ If the blade continues to turn: pull out the activation key, remove the battery and consult a STIHL specialist dealer.
- The lawn mower is defective.

12.2 Switching the Drive On and Off

12.2.1 Engaging Self-propulsion

The lever can be used to preselect the maximum possible driving speed in five stages. Pushing the lever towards increases the maximum possible driving speed, pushing it towards reduces it. Self-propulsion is disengaged in the position.

The control bar for self-propulsion can be used to continuously regulate the speed from 2.0 km/h up to the preselected maximum speed. The further the control bar for self-propulsion is pulled towards the handlebar, the higher the speed, 22.1.

The set speed influences the battery life. The lower the speed, the longer the battery life.

- ▶ Place the lawn mower on a level surface.
- ▶ Activate the blade.

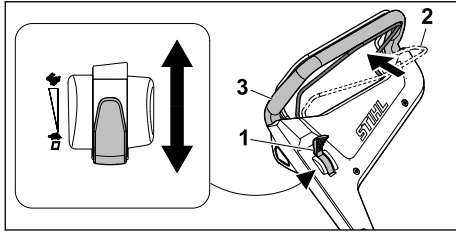

- ▶ Move lever (1) to the desired position.
- ▶ Pull control bar for self-propulsion (2) fully in the direction of handlebar (3) and hold so the thumb encloses handlebar (2). The lawn mower starts moving.

12.2.2 Deactivating Drive System

- ▶ Release the control bar for self-propulsion.
- ▶ Wait until the mower comes to a standstill.
- ▶ If the mower does not stop: Pull out the activation key, remove the battery and consult a STIHL specialist dealer for assistance. There is a malfunction in the mower.

13 Checking the Lawn Mower and Battery

13.1 Checking the Controls

Lockout button and switch lever for blade drive

- ▶ Pull out the activation key.
- ▶ Remove the battery.
- ▶ Depress the lockout button and release it again.
- ▶ Pull the switch lever for blade drive fully in direction of handle and release it again.
- ▶ If the lockout button or switch lever for blade drive is stiff or does not spring back to the idle position: Do not use your mower and contact your STIHL servicing dealer for assistance. There is a malfunction in the lockout button or switch lever.

Switch lever for wheel drive

- ▶ Pull out the activation key.
- ▶ Remove the battery.
- ▶ Pull the switch lever for wheel drive fully in direction of handle and release it again.
- ▶ If the switch lever for wheel drive is stiff or does not spring back to its idle position: Do not use your mower and contact your STIHL servicing dealer for assistance. There is a malfunction in the switch lever for wheel drive.

Lever

- ▶ Pull out the activation key.

- ▶ Remove the battery.
- ▶ Move lever to and then to .
- ▶ If the lever moves too freely: Do not use your mower and contact your STIHL servicing dealer for assistance. The lever is defective.

Switching on the mower

- ▶ Insert the activation key.
- ▶ Fit the battery.
- ▶ Depress the lockout button with your right hand and hold it there.
- ▶ Pull the switch lever for blade drive fully in direction of the handle with your left hand and hold it so that your thumb is wrapped around the handle. The blade rotates.
- ▶ If 3 LEDs flash red: Remove the activation key and battery, and contact your STIHL servicing dealer for assistance. There is a malfunction in the mower.
- ▶ Release lockout button and switch lever for blade drive. The blade stops rotating after a brief delay.
- ▶ If the blade continues to rotate: Remove the activation key and battery, and contact your STIHL servicing dealer for assistance. There is a malfunction in the mower.

Switching on wheel drive

- ▶ Insert the activation key.
- ▶ Fit the battery.
- ▶ Pull the switch lever for wheel drive fully in direction of the handle and hold it so that your thumb is wrapped around the handle. The mower begins to move forwards.
- ▶ Release the switch lever for wheel drive. The mower comes to a standstill.
- ▶ If the mower does not stop: Remove the battery and contact your STIHL dealer for assistance. There is a malfunction in the mower.

13.2 Checking the Blade

- ▶ Switch the lawn mower off, pull out the activation key and remove the battery.
- ▶ Upend the lawn mower, 18.1.

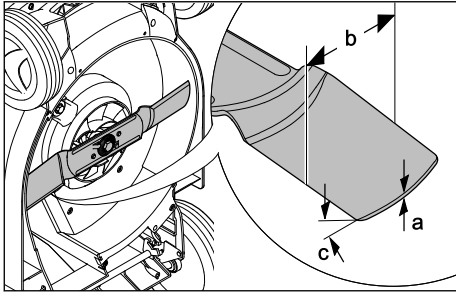

- ▶ Measure the following:
 - Thickness a
 - Width b
 - Sharpening angle c
- ▶ If the minimum thickness or minimum width are fallen below: replace the blade, [22.2](#).
- ▶ If the sharpening angle is not observed: sharpen the blade, [22.2](#).
- ▶ If anything is unclear: consult a STIHL specialist dealer.

13.3 Testing the Battery

- ▶ Press button on battery. The LEDs glow or flash.
- ▶ If the LEDs do not glow or flash: Do not use the battery and contact your STIHL servicing dealer. There is a malfunction in the battery.

14 Operating the Lawn Mower

14.1 Holding and Guiding the Lawn Mower

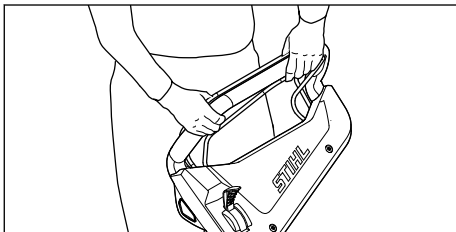

- ▶ Hold the handlebar with both hands so the thumbs enclose the handlebar.

14.2 Adjusting the Cutting Height

Six cutting heights can be set:

- 25 mm = position 1
- 30 mm = position 2
- 40 mm = position 3
- 50 mm = position 4
- 60 mm = position 5
- 75 mm = position 6

The positions are indicated on the lawn mower.

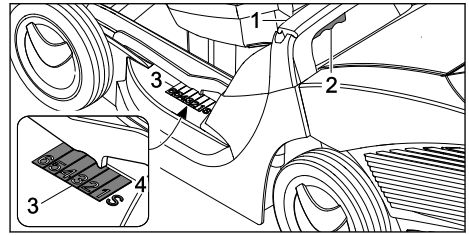

- ▶ Hold the lawn mower at handle (1).
- ▶ Press and hold lever (2).
- ▶ Move the lawn mower to the desired position by raising and lowering the lever. The current cutting height can be read off at cutting height indicator (3) by means of marking (4).
- ▶ Release lever (2). The lawn mower engages.

14.3 Activating ECO Mode

When ECO mode is activated, the lawn mower detects the current working conditions and adjusts the blade speed automatically.

This may extend the battery life.

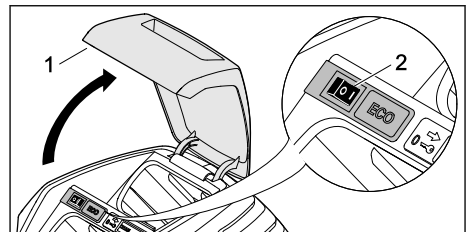

- ▶ Open flap (1) as far as the stop and hold.
- ▶ Set ECO switch (2) to the I position.
- ▶ Close flap (1).

14.4 Mowing



- ▶ If working with self-propulsion engaged: drive the lawn mower forwards in a controlled manner.
- ▶ If working with self-propulsion disengaged: push the lawn mower forwards slowly and in a controlled manner.

14.5 Emptying the Grass Catcher Box

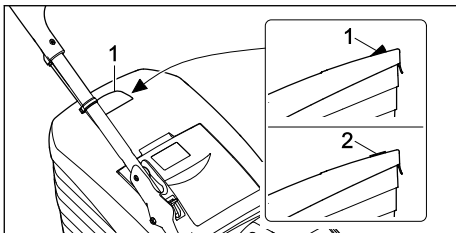

The flow of air generated by the blade raises level indicator (1). The flow of air stops when the grass catcher box is full. If the flow of air is too low, level indicator (2) returns to its resting state. This is a prompt to empty the grass catcher box.

The functionality of the level indicator is restricted if the flow of air is impaired. External influences such as wet, dense or high grass, low cutting levels, contamination or the like can impair the flow of air and the functionality of the level indicator.

- ▶ If the level indicator drops to its resting state: empty the grass catcher box.
- ▶ Switch the lawn mower off.

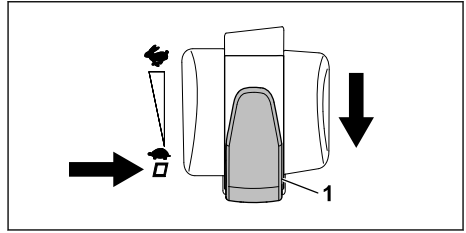

- ▶ Set driving speed lever (1) to the □ position.
- ▶ Detach the grass catcher box.

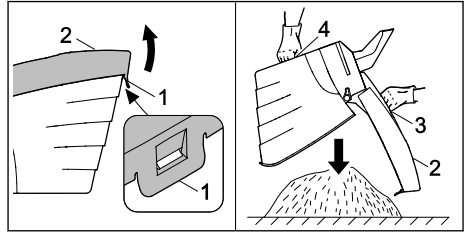

- ▶ Open tab (1).
- ▶ Open upper part of grass catcher box (2) by handle (3) and hold.
- ▶ Hold lower handle (4) with the second hand.
- ▶ Empty the grass catcher box.
- ▶ Close the grass catcher box.
- ▶ Attach the grass catcher box.

15 After Finishing Work

15.1 After Finishing Work

- ▶ Switch off the mower, remove the activation key and battery.
- ▶ If the mower is wet: Allow the mower to dry.
- ▶ If the battery is wet: Allow the battery to dry.
- ▶ Clean the mower.
- ▶ Clean the battery.

16 Transporting

16.1 Transporting the Lawn Mower

- ▶ Switch the lawn mower off.
The blade must not be turning.
- ▶ Pull out the activation key and remove the battery.

Pushing the lawn mower

- ▶ Push the lawn mower forwards slowly and in a controlled manner.

Carrying the lawn mower

- ▶ Wear work gloves made from resistant material.

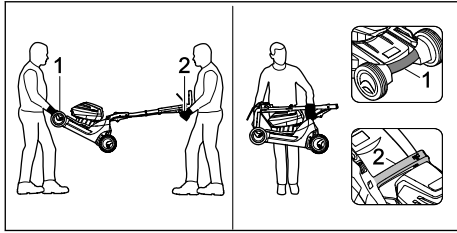

- ▶ If the lawnmower is being carried by two people:
 - ▶ One person holds the lawnmower by transport handle (1) using both hands and another person holds handlebar (2) using both hands.
 - ▶ The lawnmower must be lifted and carried by two people.
- ▶ If the lawnmower is being carried by one person:
 - ▶ Fold down the handlebar.
 - ▶ Hold the lawnmower with one hand on transport handle (1) and the other hand on handle (2).
 - ▶ Lift and carry the lawnmower.

Transporting the lawnmower in a vehicle

- ▶ Secure the lawnmower upright so that the lawnmower does not tip over and cannot move.

16.2 Transporting the Battery

- ▶ Switch the lawnmower off and remove the battery.
- ▶ Make sure that the battery is in safe condition.
- ▶ Pack the battery in such a way that it cannot move in the packaging.
- ▶ Secure the packaging so it cannot move.

The battery is subject to the requirements for transporting hazardous goods. The battery is classed as a UN 3480 (lithium-ion battery) and has been tested in accordance with the UN Manual of Tests and Criteria, Part III, subsection 38.3.

Please refer to www.stihl.com/safety-data-sheets for transport instructions.

17 Storing

17.1 Storing the Lawn Mower

- ▶ Switch the lawnmower off, pull out the activation key and remove the battery.
- ▶ Store the lawnmower in accordance with the following conditions:
 - The lawnmower is out of reach of children.
 - The lawnmower is clean and dry.

- The lawnmower cannot tip over.
- The lawnmower cannot roll away.

17.2 Storing the Battery

STIHL recommends storing the battery at a charge state between 40% and 60% (2 LEDs illuminated green).



- ▶ Store the battery in accordance with the following conditions:
 - The battery is out of reach of children.
 - The battery is clean and dry.
 - The battery is in a closed room.
 - The battery is separate from the lawnmower.
 - If the battery is stored in the charger: disconnect the mains plug and store the battery at a charge state between 40% and 60% (2 LEDs illuminated green).
 - The battery is in the temperature range between - 10 °C and + 50 °C.

NOTICE

- If the battery is not stored as described in this instruction manual, the battery may become deeply discharged and irreparably damaged.
 - ▶ Charge a discharged battery before storing it. STIHL recommends storing the battery at a charge state between 40% and 60% (2 LEDs illuminated green).
 - ▶ Store the battery separately from the lawnmower.

18 Cleaning

18.1 Placing the Lawn Mower in the Cleaning Position

- ▶ Switch the lawnmower off, pull out the activation key and remove the battery.
- ▶ Place the lawnmower on a level surface.
- ▶ Detach the grass catcher box.
- ▶ Set the cutting height to the highest setting.  14.2
- ▶ Move the upper handlebar to the lowest position,  9.1.

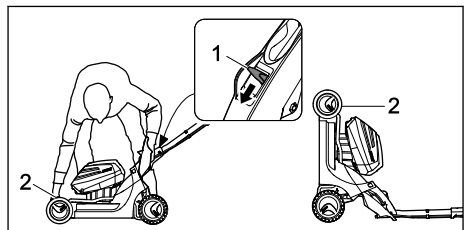

- ▶ Press lever (1) downwards with the left hand and hold.
- ▶ Hold the lawn mower at transport handle (2) with the right hand and upend.

18.2 Cleaning the Lawn Mower

- ▶ Switch the lawn mower off, pull out the activation key and remove the battery.
- ▶ Clean the lawn mower with a damp cloth.
- ▶ Clean the discharge chute with a soft brush or a damp cloth.
- ▶ Remove any foreign bodies from the battery compartment and clean the battery compartment with a damp cloth.
- ▶ Clean the electric contacts in the battery compartment with a paintbrush or a soft brush.
- ▶ Clean the ventilation slots with a paintbrush.
- ▶ Upend the lawn mower.
- ▶ Clean the area around the blade and the blade with a stick, a soft brush or a damp cloth.

18.3 Cleaning the Battery

- ▶ Clean the battery with a damp cloth.

19 Maintenance

19.1 Removing and Attaching the Blade

19.1.1 Removing the Blade

- ▶ Switch the lawn mower off, pull out the activation key and remove the battery.
- ▶ Upend the lawn mower.

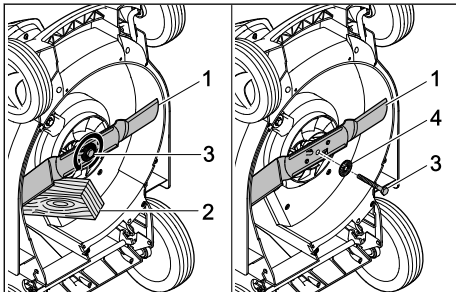

- ▶ Block blade (1) using a piece of wood (2).
- ▶ Unscrew screw (3) in the direction of the arrow and remove together with washer (4).
- ▶ Remove blade (1).
- ▶ Discard screw (3) and washer (4). Use a new screw and washer to attach blade (1).

19.1.2 Attaching the Blade

- ▶ Switch the lawn mower off, pull out the activation key and remove the battery.

- ▶ Upend the lawn mower.

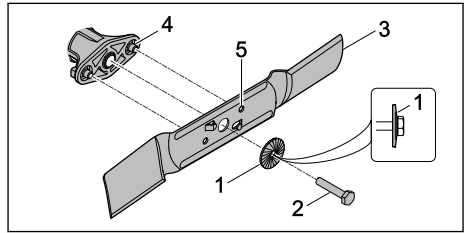

- ▶ Lay new washer (1) on new screw (2) with the convex side facing outwards.
- ▶ Apply Loctite 243 thread locker to the thread of screw (2).
- ▶ Position blade (3) so that the raised areas on contact area (4) engage in notches (5).
- ▶ Screw in screw (2) together with washer (1).

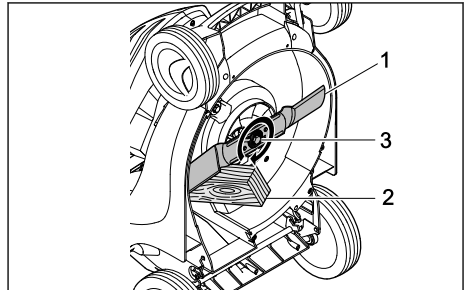

- ▶ Block blade (1) using a piece of wood (2).
- ▶ Tighten screw (3) to 65 Nm.

19.2 Sharpening and Balancing the Blade

Sharpening and balancing the blade correctly requires a lot of practice.

STIHL recommends having the blade sharpened and balanced by a STIHL specialist dealer.

⚠ WARNING

- The cutting edges of the blade are sharp. This may result in the user cutting themselves.
 - ▶ Wear work gloves made from resistant material.
- ▶ Switch the lawn mower off, pull out the activation key and remove the battery.
- ▶ Upend the lawn mower.
- ▶ Remove the blade.
- ▶ Sharpen the blade. Observe the sharpening angle and cool the blade, 22.2. Bluing of the blade during sharpening is not permitted.
- ▶ Attach the blade.

- ▶ If anything is unclear: consult a STIHL specialist dealer.

20 Repairing

20.1 Repairing the Mower and Battery

The mower, blade and battery cannot be repaired by the user.



- ▶ If the mower or the blade is damaged: Do not use your mower and contact your STIHL servicing dealer for assistance.
- ▶ If the battery has a malfunction or is damaged: Replace the battery.
- ▶ If safety labels are illegible or damaged: Have the labels replaced by a STIHL servicing dealer.

21 Troubleshooting

21.1 Remediating Lawn Mower or Battery Faults

Fault	LEDs on the battery	Cause	Remedy
The lawn mower does not start when switched on.	1 LED flashes green.	The battery charge state is too low.	▶ Charge the battery.
	1 LED illuminates red.	The battery is too warm or too cold.	▶ Pull out the activation key. ▶ Remove the battery. ▶ Allow the battery to cool down or warm up.
	3 LEDs flash red.	There is a fault in the lawn mower.	▶ Pull out the activation key. ▶ Remove the battery. ▶ Clean the electric contacts in the battery compartment. ▶ Fit the battery. ▶ Switch the lawn mower on. ▶ If 3 LEDs still flash red: do not use the lawn mower and consult a STIHL specialist dealer.
	3 LEDs illuminate red.	The lawn mower is too warm.	▶ Pull out the activation key. ▶ Remove the battery. ▶ Allow the lawn mower to cool down.
	4 LEDs flash red.	There is a fault in the battery.	▶ Remove the battery and fit it again. ▶ Switch the lawn mower on. ▶ If 4 LEDs still flash red: do not use the battery and consult a STIHL specialist dealer.
		The electrical connection between the lawn mower and battery has been interrupted.	▶ Pull out the activation key. ▶ Remove the battery. ▶ Clean the electric contacts in the battery compartment. ▶ Insert the activation key. ▶ Fit the battery.
		The lawn mower or battery is damp.	▶ Pull out the activation key. ▶ Remove the battery. ▶ Clean the lawn mower. ▶ Allow the lawn mower or battery to dry.
		The resistance at the blade is too great.	▶ Set a higher cutting height. ▶ Switch the lawn mower on in lower grass.
		The area around the blade is blocked.	▶ Clean the lawn mower.
Self-propulsion is not working.		There is a fault in the self-propulsion mechanism.	▶ Consult a STIHL specialist dealer.

Fault	LEDs on the battery	Cause	Remedy
The lawn mower stops during operation.	3 LEDs illuminate red.	The lawn mower is too warm.	<ul style="list-style-type: none"> ▶ Pull out the activation key. ▶ Remove the battery. ▶ Allow the lawn mower to cool down. ▶ Clean the lawn mower. ▶ Do not switch the lawn mower on too frequently within a short time. ▶ If working with self-propulsion engaged: switch off self-propulsion. ▶ If working with self-propulsion disengaged: go forwards slower. ▶ Set a higher cutting height. ▶ Mow shorter grass.
		The blade is blocked.	<ul style="list-style-type: none"> ▶ Pull out the activation key. ▶ Remove the battery. ▶ Clean the lawn mower.
		There is an electrical fault.	<ul style="list-style-type: none"> ▶ Remove the battery and fit it again. ▶ Switch the lawn mower on.
The lawn mower vibrates excessively during operation.		The blade fastening screw is loose.	<ul style="list-style-type: none"> ▶ Tighten the screw.
		The blade is not correctly balanced.	<ul style="list-style-type: none"> ▶ Sharpen and balance the blade.
The lawn mower operating time is too short.		The battery is not fully charged.	<ul style="list-style-type: none"> ▶ Fully charge the battery.
		The battery service life has been exceeded.	<ul style="list-style-type: none"> ▶ Replace the battery.
		The area around the blade is blocked.	<ul style="list-style-type: none"> ▶ Clean the lawn mower.
		The blade is blunt or worn.	<ul style="list-style-type: none"> ▶ Sharpen and balance the blade.
		The resistance at the blade is too great.	<ul style="list-style-type: none"> ▶ If working with self-propulsion engaged: switch off self-propulsion. ▶ If working with self-propulsion disengaged: go forwards slower. ▶ Set a higher cutting height. ▶ Mow shorter grass.
The battery gets stuck when fitting it into the battery compartment.		The guides or electric contacts in the battery compartment are dirty.	<ul style="list-style-type: none"> ▶ Clean the lawn mower.
Charging fails to start after fitting the battery into the charger.	1 LED illuminates red.	The battery is too warm or too cold.	<ul style="list-style-type: none"> ▶ Leave the battery inserted in the charger. <p>Charging starts automatically as soon as the permissible temperature range is reached.</p>
The grass has not been cut cleanly or the lawn is yellow.		The blade is blunt or worn.	<ul style="list-style-type: none"> ▶ Sharpen and balance the blade.
		The resistance at the blade is too great.	<ul style="list-style-type: none"> ▶ If working with self-propulsion engaged: switch off self-propulsion. ▶ If working with self-propulsion disengaged: go forwards slower. ▶ Set a higher cutting height.

Fault	LEDs on the battery	Cause	Remedy
			► Mow shorter grass.
The STIHL connected app cannot find the battery with  .		The Bluetooth® radio interface on the battery or on the mobile device is disabled.	► Enable the Bluetooth® radio interface on the battery and on the mobile device.
		The distance between the battery and the mobile device is too great.	► Reduce the distance,  22.3. ► If the battery still cannot be found with the STIHL connected app: consult a STIHL specialist dealer.

21.2 Product Support and Assistance on Use

Product support and assistance on use are available from STIHL servicing dealers.

For contacts and other information, please visit <https://support.stihl.com> or www.stihl.com.

22 Specifications

22.1 STIHL RMA 443.2 VC, RMA 443.2 PV, RMA 448.2 VC, RMA 448.2 PV Lawn Mower

- Permissible battery: STIHL AP
- weight without battery:
 - rma 443.2 vc: 23 kg
 - rma 443.2 pv: 24 kg
 - rma 448.2 vc: 24 kg
 - rma 448.2 pv: 24 kg
- Maximum grass catcher box capacity: 55 l
- Cutting width:
 - RMA 443.2 VC, RMA 443.2 PV: 41 cm
 - RMA 448.2 VC, RMA 448.2 PV: 46 cm
- Speed: 3,150 rpm
- Speed in ECO mode: 2,800 rpm
- Minimum driving speed: 2.0 km/h
- Maximum driving speed (depending on the battery used):
 - with AP 100: 3.0 km/h
 - with AP 200: 3.7 km/h
 - with AP 300: 4.5 km/h

For information on the battery life see www.stihl.com/battery-life.

22.2 Blade

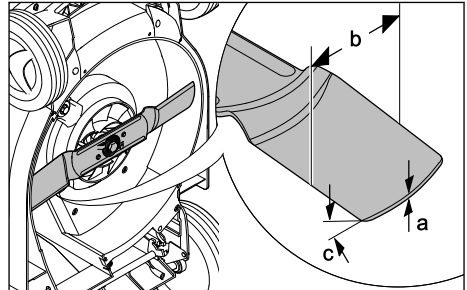

- Minimum thickness a: 2 mm
- Minimum width b: 55 mm
- Sharpening angle c: 30°

22.3 STIHL AP battery

- Battery technology: lithium-ion
- Voltage: 36 V
- Capacity in Ah: see rating label
- Energy content in Wh: see rating label
- Weight in kg: see rating label
- Permissible temperature range for operation and storage: + 10 °C to + 50 °C
- Bluetooth® radio interface (only for batteries with ):

- Data connection: Bluetooth® 5.1. The mobile appliance must be compatible with Bluetooth® Low Energy 5.0 and support Generic Access Profile (GAP).
- Frequency band: ISM band 2.4 GHz
- Maximum RF power transmitted: 1 mW
- Signal range: approx. 10 m. The signal strength depends on the ambient conditions and the mobile terminal. Signal range can vary greatly depending on local conditions, including the receiver. The range may be perceptibly reduced inside enclosed rooms and through metal barriers (such as walls, shelves or cases).
- Mobile appliance operating system requirements: Android or iOS (current version or higher)

22.4 Sound Values and Vibration Values

RMA 443.2 VC, RMA 443.2 PV

The K value for the sound pressure level is 2 dB(A). The K value for the sound power level is 1.2 dB(A). The K value for the vibration value is 1.10 m/s².

- Sound pressure level L_{pA} measured in accordance with EN 60335-2-77: 75 dB(A)
- Guaranteed sound power level L_{WAd} measured in accordance with 2000/14/EC / S.I. 2001/1701: 90 dB(A)
- Vibration value a_{hv} measured in accordance with EN 20643, EN 60335-2-77, handlebar: 2.20 m/s²

RMA 448.2 VC, RMA 448.2 PV

The K value for the sound pressure level is 2 dB(A). The K value for the sound power level is 1.2 dB(A). The K value for the vibration value is 0.9 m/s².

- Sound pressure level L_{pA} measured in accordance with EN 60335-2-77: 80 dB(A)
- Guaranteed sound power level L_{WAd} measured in accordance with 2000/14/EC / S.I. 2001/1701: 94 dB(A)
- Vibration value a_{hv} measured in accordance with EN 20643, EN 60335-2-77, handlebar: 1.8 m/s²

The indicated vibration values were measured in accordance with a standardised test method and can be used for the purpose of comparing electrical appliances. The actual vibration values that occur may deviate from the indicated values, depending on the type of application. The indica-

ted vibration values can be used for an initial assessment of the vibration load. The actual vibration load must be assessed. Times during which the electrical appliance is switched off, along with times during which it is switched on but running without load, can also be taken into consideration.

For information on compliance with Employers' Vibration Directive 2002/44/EC and S.I. 2005/1093, see www.stihl.com/vib.

22.5 REACH

REACH is an EC regulation and stands for the Registration, Evaluation, Authorisation and Restriction of Chemical substances.

For information on compliance with the REACH regulation see www.stihl.com/reach.

23 Spare Parts and Accessories

23.1 Spare parts and accessories

STIHL  These symbols indicate original STIHL spare parts and original STIHL accessories.

STIHL recommends the use of original STIHL spare parts and accessories.

Despite ongoing market observation, STIHL is unable to judge the reliability, safety and suitability of other manufacturers' spare parts and accessories; accordingly, STIHL cannot warrant for the use of those parts.

Original STIHL spare parts and original STIHL accessories are available from STIHL dealers.

23.2 Essential Spare Parts

- Blade RMA 443.2 VC, RMA 443.2 PV: 6338 702 0130
- Blade RMA 448.2 VC, RMA 448.2 PV: 6358 702 0115
- Blade fastening screw: 9008 319 9028
- Washer: 0000 702 6600

24 Disposal

24.1 Disposing of the Lawn Mower

Information on disposal is available from your local authority or from a STIHL dealer.

Improper disposal may be harmful to health and pollute the environment.

- ▶ Take STIHL products including packaging to a suitable collection point for recycling in accordance with local regulations.
- ▶ Do not dispose of the product with domestic waste.

25 EC Declaration of Conformity

25.1 STIHL RMA 443.2 VC, RMA 443.2 PV, RMA 448.2 VC, RMA 448.2 PV Lawn Mower

STIHL Tirol GmbH
Hans Peter Stihl-Strasse 5
6336 Langkampfen

Austria

declares under our sole responsibility that

- design: cordless lawn mower
- manufacturer's brand: STIHL
- type: RMA 443.2 VC, RMA 443.2 PV,
RMA 448.2 VC, RMA 448.2 PV
- cutting width:
 - RMA 443.2 VC, RMA 443.2 PV: 41 cm
 - RMA 448.2 VC, RMA 448.2 PV: 46 cm
- serial number:
 - RMA 443.2 VC, RMA 443.2 PV: 6338
 - RMA 448.2 VC, RMA 448.2 PV: 6358

complies with the relevant provisions of Directives 2000/14/EC, 2006/42/EC, 2014/30/EU and 2011/65/EU and has been developed and manufactured in accordance with the versions of the following standards valid on the date of manufacture: EN 60335-1, EN 60335-2-77, EN 55014-1 and EN 55014-2.

Approved body involved:

TÜV Rheinland LGA Products GmbH
Tillystrasse 2
90431 Nuremberg, Germany

The measured and guaranteed sound power levels were determined in accordance with Directive 2000/14/EC, Appendix VIII.

- Measured sound power level RMA 443.2 VC,
RMA 443.2 PV: 89.2 dB(A)
- Guaranteed sound power level
RMA 443.2 VC, RMA 443.2 PV: 90 dB(A)
- Measured sound power level RMA 448.2 VC,
RMA 448.2 PV: 93.2 dB(A)
- Guaranteed sound power level
RMA 448.2 VC, RMA 448.2 PV: 94 dB(A)

The technical documents are stored at STIHL Tirol GmbH.

The year of manufacture and machine number are indicated on the lawn mower.

Langkampfen, 02.01.2020

STIHL Tirol GmbH

p.p. 

Matthias Fleischer, Head of Research and Development Division

p.p. 

Sven Zimmermann, Head of Quality Department

26 UKCA Declaration of Conformity

26.1 STIHL RMA 443.2 VC, RMA 448.2 VC Lawn Mower

STIHL Tirol GmbH
Hans Peter Stihl-Strasse 5
6336 Langkampfen

Austria

declares under our sole responsibility that

- design: cordless lawn mower
- manufacturer's brand: STIHL
- type: RMA 443.2 VC, RMA 448.2 VC
- cutting width:
 - RMA 443.2 VC: 41 cm
 - RMA 448.2 VC: 46 cm
- serial number:
 - RMA 443.2 VC: 6338
 - RMA 448.2 VC: 6358

complies with the relevant provisions of the UK regulations Noise Emission in the Environment by Equipment for Use Outdoors Regulations 2001, Supply of Machinery (Safety) Regulations 2008, Electromagnetic Compatibility Regulations 2016 and Restriction of the Use of Certain Hazardous Substances in Electrical and Electronic Equipment Regulations 2012 and has been developed and manufactured in accordance with the versions of the following standards valid on the date of manufacture: EN 60335-1, EN 60335-2-77, EN 55014-1 and EN 55014-2.

Approved body involved:

TUV Rheinland UK Ltd
1011 Stratford Road
Solihull, B90 4BN

The measured and guaranteed sound power levels were determined in accordance with the UK regulation Noise Emission in the Environment by Equipment for Use Outdoors Regulations 2001, Schedule 11.

- Measured sound power level, RMA 443.2 VC: 89.2 dB(A)
- Guaranteed sound power level, RMA 443.2 VC: 90 dB(A)
- Measured sound power level, RMA 448.2 VC: 93.2 dB(A)
- Guaranteed sound power level, RMA 448.2 VC: 94 dB(A)

The technical documents are stored at STIHL Tirol GmbH.

The year of manufacture and machine number are indicated on the lawn mower.

Langkampfen, 01.07.2022

STIHL Tirol GmbH

p.p. 

Matthias Fleischer, Head of Research and Development Division

p.p. 

Sven Zimmermann, Head of Quality Division

27 Safety Information for Lawn Mowers

27.1 Introduction

This chapter describes the general safety instructions preformulated in the standard EN 60335-2-77, Annex EE, for electrically operated lawn mowers.

WARNING

- **Read all the safety instructions, instructions, illustrations and technical data provided with the lawn mower.** Failure to comply with the following instructions may cause electrical shock, fire and/or serious injury. **Keep all safety instructions and instructions for the future.**

27.2 Training

- a) Read the instruction manual carefully. Ensure that you are familiar with the controls and the correct use of the machine;

- b) Never allow children or other persons who are not familiar with the instructions for use to use the lawn mower. Local regulations may specify a minimum age for users;
- c) Never mow in the vicinity of other persons, particularly children or animals;
- d) Be aware that the person operating the machine or the user is responsible for accidents involving third parties or their property.

27.3 Preparatory Measures

- a) Always wear sturdy shoes and long trousers when operating the machine. Never operate the machine barefoot or in lightweight sandals. Avoid wearing loose clothing or clothing with hanging cords or belts.
- b) Inspect the area on which the machine is to be used and remove any objects that could be taken in and thrown up by the machine.
- c) Before using the machine, always visually inspect the cutting blade, the retaining pins and the entire cutting unit for wear or damage. To avoid imbalance, worn or damaged cutting blades and retaining pins must be replaced in pairs. Worn or damaged warning signs must be replaced.

27.4 Handling

- a) Only mow during the day or with good artificial light.
- b) If possible, avoid using the machine when the grass is wet.
- c) Always ensure good stability on slopes.
- d) Operate the machine only at walking pace.
- e) Only mow across and never up or down the slope.
- f) Be particularly careful when changing direction on a slope.
- g) Do not mow on excessively steep slopes.
- h) Be particularly careful when turning the lawn mower around or pulling it towards you.
- i) Stop the cutting blade(s) when the machine needs to be tilted for transportation over surfaces other than grass and when moving the lawn mower from and to the area to be mown.
- j) Never use the lawn mower with damaged safety devices or protective grilles or without attached safety devices, e.g. deflectors and/or grass-catching units.

- k) Exercise care when starting or pressing the starting switch and observe the manufacturer's instructions. Ensure that you keep your feet far enough away from the cutting blade(s).
- l) The lawn mower must not be tilted when starting it, unless the lawn mower needs to be lifted during the process. In this case, only tilt it as far as is absolutely necessary and only raise the side facing away from the user.
- m) Do not start the motor when you are standing in front of the discharge chute.
- n) Never put hands or feet on or underneath rotating parts. Always keep away from the discharge opening.
- o) Never lift or carry a lawn mower with the motor running.
- p) Stop the motor and pull out the starting key. Ensure that all moving parts have come to a complete stop:
 - whenever you leave the lawn mower;
 - before remedying blockages, including those in the discharge chute;
 - before checking, cleaning or working on the lawn mower;
 - after hitting a foreign object. Inspect the lawn mower for damage and perform the necessary repairs before re-starting and using the lawn mower.If the lawn mower begins to vibrate excessively, it must be checked immediately.
 - Check for damage;
 - make the necessary repairs to damaged parts;
 - ensure that all screws, pins and bolts are tightly fastened.

27.5 Maintenance and Storage

- a) Ensure that all nuts, pins and bolts are tightly fastened and that the machine is in a safe working condition.
- b) Check the grass-catching unit regularly for wear or loss of functionality.
- c) In the interests of safety, replace all worn or damaged parts.
- d) Be aware that on machines with more than one cutting blade, the movement of one cutting blade can cause the other cutting blade to turn.
- e) Ensure when adjusting the machine that your fingers do not become pinched between

- moving cutting blades and stationary parts of the machine.
- f) Allow the motor to cool down before storing the machine.
- g) Note when maintaining the cutting blades that the cutting blades can be moved even if the power source is switched off.
- h) In the interests of safety, replace all worn or damaged parts. Only use genuine spare parts and accessories.